

HYDRAULIC CYLINDER FOR 7 MPa (Type T-HC) $\phi 20 / \phi 25 / \phi 30$

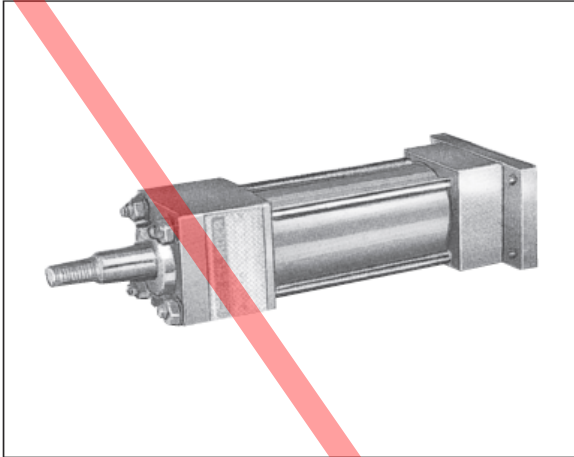

■ Features

- Five mount types can be configured by assembling the relevant accessories on the base model.
 - The cylinder is highly wear resistant since the cylinder tube internal face is finished by precision honing and the piston rod is coated by hard chromium plating.
 - The sliding section of the piston rod adopts a PS seal that features high durability.
- The cushion and air bleeder cannot be installed.

■ Description of the model designation

T-HC1-20×50-(FA)-(A)

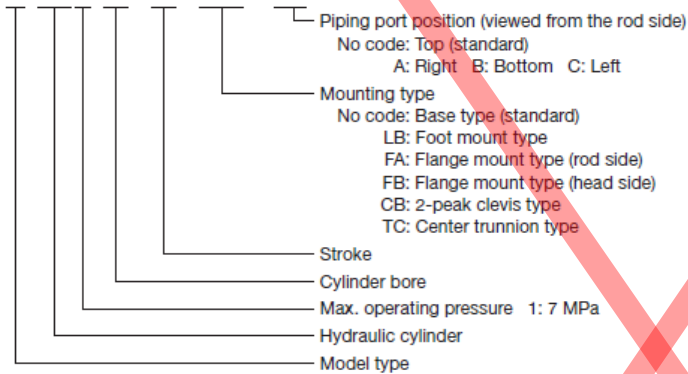

■ Specifications

Max. operating pressure	7 MPa	
Min. working pressure	Head side	0.3 MPa
	Rod side	0.4 MPa
Operating speed range	8 to 150 mm/s	
Operating temperature range	0 to 60 °C	

■ Standard stroke

Model	Max. available stroke (mm)
T-HC1-20	600
T-HC1-25	600
T-HC1-30	600

NOTE: A cylinder with a stroke of more than 600 mm cannot be manufactured.

■ Permissible stroke error

Stroke	100 or less	100 to 250	250 to 500
Permissible error	+0.8 0	+1.0 0	+1.25 0



Outside dimensions

Standard

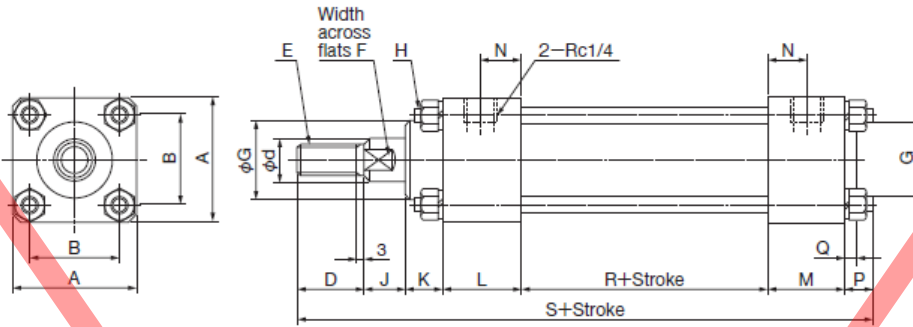

Model	Symbol (Unit: mm)																
	A	B	D	E	F	d (r6)	G (h8)	H	J	K	L	M	N	P	Q	R	S
T-HC1-20x*	45	33	20	M 8x1.0	8	10	28	M6	15	13	28	28	14	9	3	45	158
T-HC1-25x*	45	33	20	M 8x1.0	8	10	28	M6	15	13	28	28	14	9	3	45	158
T-HC1-30x*	45	33	25	M12x1.25	13	15	28	M6	15	13	28	28	14	9	3	45	163

LB (Foot mount type)

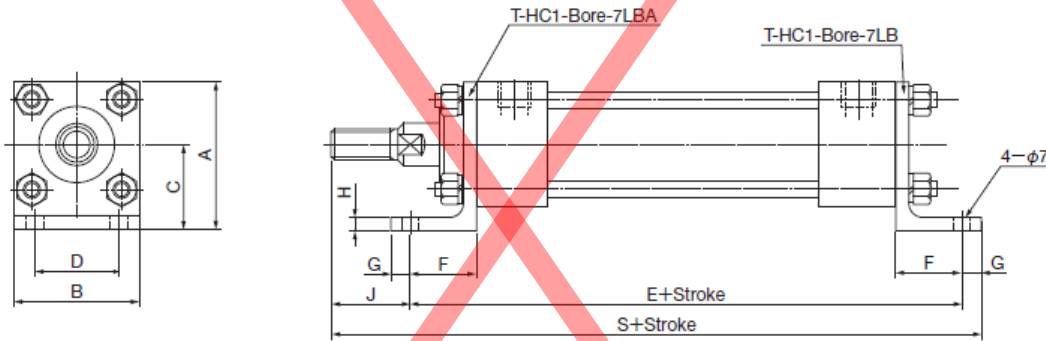

Model	Symbol (Unit: mm)									
	A	B	C	D	E	F	G	H	J	S
T-HC1-20x*-LB	54.5	45	32	30	151	25	7	5	23	181
T-HC1-25x*-LB	54.5	45	32	30	151	25	7	5	23	181
T-HC1-30x*-LB	54.5	45	32	30	151	25	7	5	23	186

FA (Rod side flange mount type)

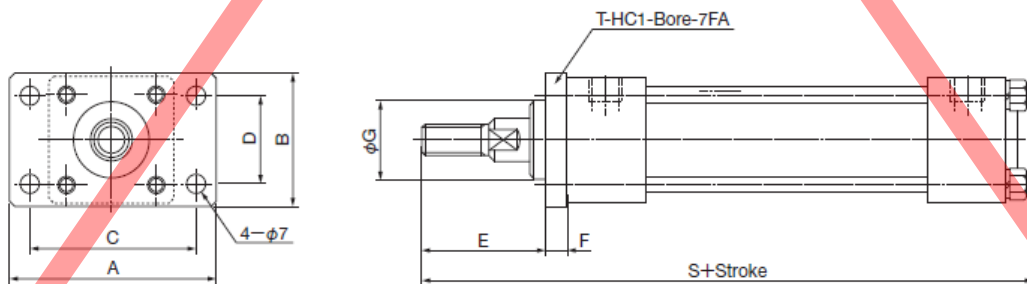

Model	Symbol (Unit: mm)							
	A	B	C	D	E	F	G (h8)	S
T-HC1-20x*-FA	75	46	62	30	40	8	28	158
T-HC1-25x*-FA	75	46	62	30	40	8	28	158
T-HC1-30x*-FA	75	46	62	30	45	8	28	163

Outside dimensions

FB (Head side flange mount type)

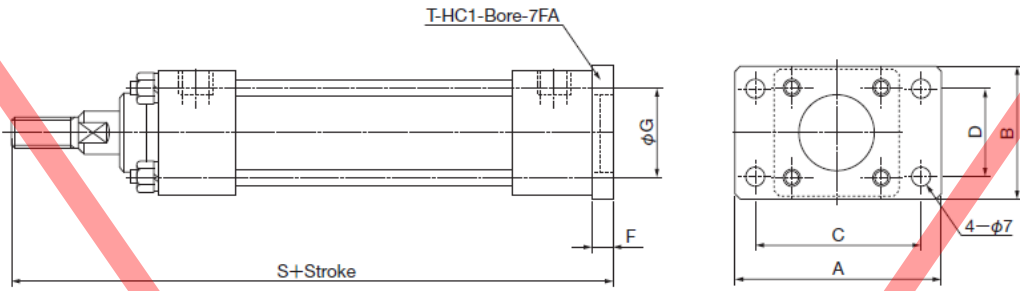

Model	Symbol (Unit: mm)						
	A	B	C	D	F	G (E9)	S
T-HC1-20x*-FB	75	46	62	30	8	28	157
T-HC1-25x*-FB	75	46	62	30	8	28	157
T-HC1-30x*-FB	75	46	62	30	8	28	162

CB (2-peak clevis type)

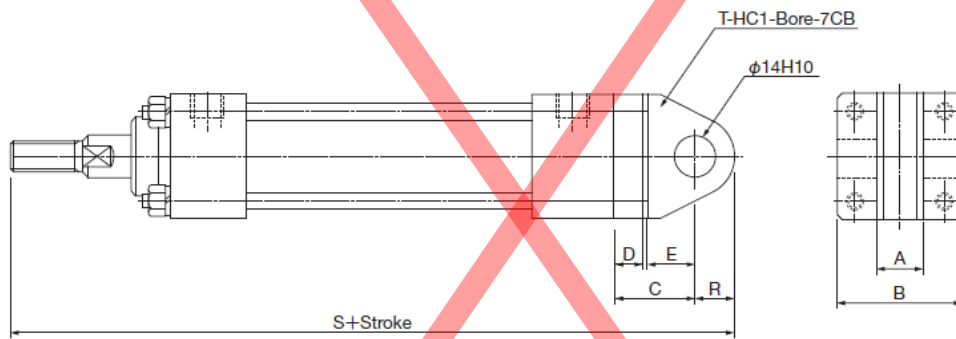

Model	Symbol (Unit: mm)						
	A	B	C	D	E	R	S
T-HC1-20x*-CB	16	45	28	10	16	14	191
T-HC1-25x*-CB	16	45	28	10	16	14	191
T-HC1-30x*-CB	16	45	28	10	16	14	196

TC (Center trunnion type)

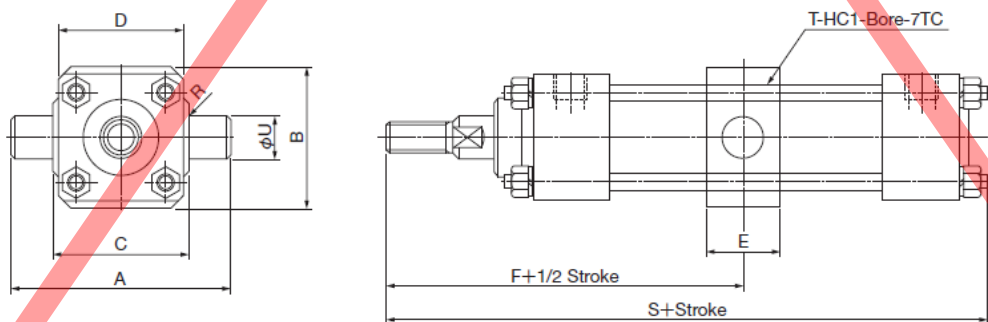

Model	Symbol (Unit: mm)								
	A	B	C	D	E	F	U (E8)	R	S
T-HC1-20x*-TC	80	50	50	40	26	98.5	15	1	158
T-HC1-25x*-TC	80	50	50	40	26	98.5	15	2	158
T-HC1-30x*-TC	80	50	50	40	26	103.5	15	2	163